

**Straight Union**  
Type FI-G • Series LL / L / S

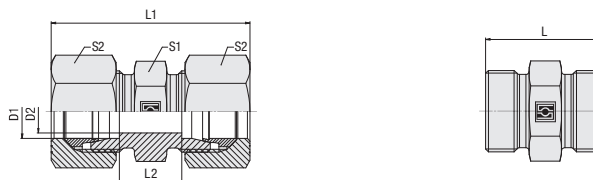

D

**Ordering Codes**

**\*FI-G\*-10\*L\*-W3\*-MS**

- \* Straight Union **FI-G**
- \* Outside Tube Diameter D1 (in mm) **-10**
- \* Series **LL**  
 Extra-Light Series **L**  
 Light Series **S**  
 Heavy Series
- \* Material Code **-W3**  
 Steel, zinc/nickel-plated
- Please contact STAUFF for alternative materials and surface finishings.
- \* Assembling / Kitting **—**  
 Fitting body only
- MS**  
 Fitting body supplied with cutting rings and union nuts
- MSV**  
 Fitting body supplied with soft-sealing cutting rings and union nuts

**Connecting Parts**

-  Cutting Ring  
Type **FI-DS** Page 26
-  Soft-Sealing Cutting Ring  
Type **FI-WDDS** Page 27
-  Support Sleeve  
Type **FI-VH** Page 28
-  STAUFF Form Ring  
Type **FI-AR** Page 30
-  Union Nut  
Type **FI-M** Page 31
-  37° Flared Tube Fitting Set  
Type **FI-AB** Page 35

Series	Tube OD	PN (bar/Psi)	Dimensions (mm/in)						Weight (kg/lbs) ca. per 100 <sup>2</sup>	Ordering Codes <sup>3</sup>	
	D1		D2	L	L1 <sup>1</sup>	L2	S1	S2			
LL	4	100	3	20	31	12	9	10	0,53	FI-G-04LL-W3	
	.16	1450	.12	.79	1.22	.47	.35	.39	1.16	FI-G-06LL-W3	
	6	100	4,5	20	32	9	11	12	0,79	FI-G-06LL-W3	
	.24	1450	.18	.79	1.26	.35	.43	.47	1.74	FI-G-08LL-W3	
	8	100	6	23	35	12	12	14	1,05	FI-G-08LL-W3	
	.31	1450	.24	.91	1.38	.47	.47	.55	2.30	FI-G-10LL-W3	
	10	100	8	23	35	12	14	17	1,29	FI-G-10LL-W3	
	.39	1450	.31	.91	1.38	.47	.55	.67	2.83	FI-G-12LL-W3	
	12	100	10	23	35	11	17	19	1,83	FI-G-12LL-W3	
	.47	1450	.39	.91	1.38	.43	.67	.75	4.03	FI-G-12LL-W3	
	L	6	500	4	24	39	10	12	14	1,44	FI-G-06L-W3
		.24	7250	.16	.94	1.54	.39	.47	.55	3.17	FI-G-08L-W3
8		500	6	25	40	11	14	17	1,90	FI-G-08L-W3	
.31		7250	.24	.98	1.57	.43	.55	.67	4.18	FI-G-10L-W3	
10		500	8	27	42	13	17	19	2,60	FI-G-10L-W3	
.39		7250	.31	1.06	1.65	.51	.67	.75	5.72	FI-G-12L-W3	
12		400	10	28	43	14	19	22	2,67	FI-G-12L-W3	
.47		5800	.39	1.10	1.69	.55	.75	.87	5.87	FI-G-12L-W3	
15		400	12	30	46	16	24	27	4,81	FI-G-15L-W3	
.59		5800	.47	1.18	1.81	.63	.94	1.06	10.57	FI-G-18L-W3	
18		400	15	31	48	16	27	32	6,65	FI-G-18L-W3	
.71		5800	.59	1.22	1.89	.63	1.06	1.26	14.63	FI-G-22L-W3	
22		250	19	35	52	20	32	36	8,94	FI-G-22L-W3	
.87		3625	.75	1.38	2.05	.79	1.26	1.42	19.66	FI-G-28L-W3	
28		250	24	36	54	21	41	41	13,90	FI-G-28L-W3	
1.10		3625	.94	1.42	2.13	.83	1.61	1.61	30.57	FI-G-35L-W3	
35		250	30	41	63	20	46	50	21,11	FI-G-35L-W3	
1.38		3625	1.18	1.61	2.48	.79	1.81	1.97	46.43	FI-G-42L-W3	
42		250	36	43	66	21	55	60	29,26	FI-G-42L-W3	
1.65		3625	1.42	1.69	2.60	.83	2.17	2.36	64.38	FI-G-42L-W3	
S	6	800	4	30	45	16	14	17	2,52	FI-G-06S-W3	
	.24	11600	.16	1.18	1.77	.63	.55	.67	5.54	FI-G-08S-W3	
	8	800	5	32	47	18	17	19	3,67	FI-G-08S-W3	
	.31	11600	.20	1.26	1.85	.71	.67	.75	8.08	FI-G-10S-W3	
	10	800	7	32	49	17	19	22	4,23	FI-G-10S-W3	
	.39	11600	.28	1.26	1.93	.67	.75	.87	9.30	FI-G-12S-W3	
	12	630	8	34	51	19	22	24	5,88	FI-G-12S-W3	
	.47	9135	.31	1.34	2.01	.75	.87	.94	12.94	FI-G-14S-W3	
	14	630	10	38	57	22	24	27	7,52	FI-G-14S-W3	
	.55	9135	.39	1.50	2.24	.87	.94	1.06	16.54	FI-G-16S-W3	
	16	630	12	38	57	21	27	30	9,20	FI-G-16S-W3	
	.63	9135	.47	1.50	2.24	.83	1.06	1.18	20.25	FI-G-20S-W3	
	20	400	16	44	66	23	32	36	14,27	FI-G-20S-W3	
	.79	5800	.63	1.73	2.60	.91	1.26	1.42	31.40	FI-G-25S-W3	
	25	400	20	50	74	26	41	46	24,99	FI-G-25S-W3	
	.98	5800	.79	1.97	2.91	1.02	1.61	1.81	54.97	FI-G-30S-W3	
	30	400	25	54	80	27	46	50	33,08	FI-G-30S-W3	
	1.18	5800	.98	2.13	3.15	1.06	1.81	1.97	72.77	FI-G-38S-W3	
38	400	32	61	90	29	55	60	53,80	FI-G-38S-W3		
1.50	5800	1.26	2.40	3.54	1.14	2.17	2.36	118.36	FI-G-38S-W3		

<sup>1</sup> Approximate dimension in assembled condition.

<sup>2</sup> Weight excluding cutting rings and union nuts.

<sup>3</sup> Standard scope of delivery: Fitting body only.

