

Straight Female Stud Fitting
Type FI-GA-...-R ■ Series L / S

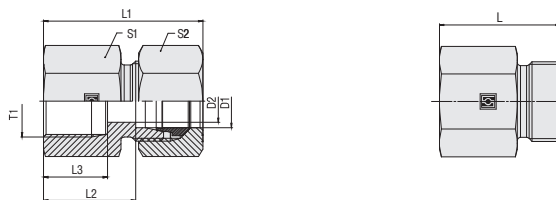

Female Whitworth Parallel Pipe Thread (BSPP)

Ordering Codes

***FI-GA*-10*L*R*-W3*-MS**

- * Straight Female Stud Fitting **FI-GA**
- * Outside Tube Diameter D1 (in mm) **-10**
- * Series **L**
Light Series
SHeavy Series
- * Thread Type **R**
Female Whitworth Parallel
Pipe Thread (BSPP)
- If required, please indicate special sizes, e.g. R3/8!
- * Material Code **-W3**
Steel, zinc/nickel-plated
- Please contact STAUFF for alternative materials and surface finishings.
- * Assembling / Kitting **—**
Fitting body only
- Fitting body supplied with cutting ring and union nut **-MS**
- Fitting body supplied with soft-sealing cutting ring and union nut **-MSV**

Connecting Parts

- Cutting Ring
Type **FI-DS** Page 26
- Soft-Sealing Cutting Ring
Type **FI-WDDS** Page 27
- Support Sleeve
Type **FI-VH** Page 28
- STAUFF Form Ring
Type **FI-AR** Page 30
- Union Nut
Type **FI-M** Page 31
- 37° Flared Tube Fitting Set
Type **FI-AB** Page 35

Series	Tube OD		PN	Dimensions									Weight (% / lbs) ca. per 100 ²	Ordering Codes ³
	(mm/in)	(mm/in)		(mm/in)	Thread T	D2	L	L1 ¹	L2	L3	S1	S2		
L	6	315	G 1/8	4	26	34	19	12	14	14	3,26	FI-GA-06LR-W3		
	.24	4568		.16	1.02	1.34	.75	.47	.55	.55	7.16			
	6	315	G 1/4	4	31	39	24	18	19	14	3,78	FI-GA-06LR1/4-W3		
	.24	4568		.16	1.22	1.54	.94	.71	.75	.55	8.32			
	8	315	G 1/4	6	31	39	24	17	19	17	3,91	FI-GA-08LR-W3		
	.31	4568		.24	1.22	1.54	.94	.67	.75	.67	8.61			
	8	315	G 3/8	6	31	39	24	16	24	17	2,28	FI-GA-08LR3/8-W3		
	.31	4568		.24	1.22	1.54	.94	.63	.94	.67	5.02			
	8	315	G 1/2	6	36	44	29	20	27	17	8,35	FI-GA-08LR1/2-W3		
	.31	4568		.24	1.42	1.73	1.14	.79	1.06	.67	18.37			
	10	315	G 1/4	8	32	40	25	17	19	19	3,95	FI-GA-10LR-W3		
	.39	4568		.31	1.26	1.57	.98	.67	.75	.75	8.69			
	10	315	G 3/8	8	32	40	25	16	24	19	4,94	FI-GA-10LR3/8-W3		
	.39	4568		.31	1.26	1.57	.98	.63	.94	.75	10.86			
	10	315	G 1/2	8	37	45	30	20	27	19	8,36	FI-GA-10LR1/2-W3		
	.39	4568		.31	1.46	1.77	1.18	.79	1.06	.75	18.39			
	12	315	G 1/4	8	33	41	26	17	19	22	4,44	FI-GA-12LR1/4-W3		
	.47	4568		.31	1.3	1.61	1.02	.67	.75	.87	9.76			
	12	315	G 3/8	10	33	41	26	17	24	22	6,43	FI-GA-12LR-W3		
	.47	4568		.39	1.3	1.61	1.02	.67	.94	.87	14.14			
	12	315	G 1/2	10	37	45	30	20	27	22	8,38	FI-GA-12LR1/2-W3		
	.47	4568		.39	1.46	1.77	1.18	.79	1.06	.87	18.44			
	15	315	G 1/2	12	38	46	31	20	27	27	8,84	FI-GA-15LR-W3		
	.59	4568		.47	1.50	1.81	1.22	.79	1.06	1.06	19.46			
	18	315	G 3/8	15	34	43	26,5	20	27	32	9,61	FI-GA-18LR3/8-W3		
	.71	4568		.59	1.34	1.69	1.04	.79	1.06	1.26	21.15			
	18	315	G 1/2	15	38	47	30,5	20	27	32	9,15	FI-GA-18LR-W3		
	.71	4568		.59	1.50	1.85	1.20	.79	1.06	1.26	20.14			
	22	160	G 3/4	19	43	52	35,5	22	36	36	17,87	FI-GA-22LR-W3		
	.87	2320		.75	1.69	2.05	1.40	.87	1.42	1.42	39.31			
28	160	G 1	24	45,5	54,5	38	24,5	41	41	21,80	FI-GA-28LR-W3			
1.1	2320		.94	1.79	2.15	1.50	.96	1.61	1.61	47.96				
35	160	G 1 1/4	30	51,5	62,5	41	26,5	55	50	47,49	FI-GA-35LR-W3			
1.38	2320		1.18	2.03	2.46	1.61	1.04	2.17	1.97	104.47				
42	160	G 1 1/2	36	53,5	65,5	42,5	28,5	60	60	53,90	FI-GA-42LR-W3			
1.65	2320		1.42	2.11	2.58	1.67	1.12	2.36	2.36	118.58				
S	6	630	G 1/4	4	33	41	26	17	19	17	4,33	FI-GA-06SR-W3		
	.24	9135		.16	1.3	1.61	1.02	.67	.75	.67	9.52			
	8	630	G 1/4	5	33	41	26	17	19	19	4,53	FI-GA-08SR-W3		
	.31	9135		.2	1.30	1.61	1.02	.67	.75	.75	9.96			
	10	630	G 3/8	7	34	43	26,5	17	24	22	6,99	FI-GA-10SR-W3		
	.39	9135		.28	1.34	1.69	1.04	.67	.94	.87	15.37			
	12	630	G 3/8	8	34	43	26,5	17	24	24	7,08	FI-GA-12SR-W3		
	.47	9135		.31	1.34	1.69	1.04	.67	.94	.94	15.57			
	12	630	G 1/2	8	38	47	30,5	20	27	24	9,23	FI-GA-12SR1/2-W3		
	.47	9135		.31	1.50	1.85	1.20	.79	1.06	.94	20.31			
	14	630	G 1/2	10	40	50	32	20	27	27	9,64	FI-GA-14SR-W3		
	.55	9135		.39	1.57	1.97	1.26	.79	1.06	1.06	21.20			
	16	630	G 1/2	12	40	50	31,5	20	27	30	9,70	FI-GA-16SR-W3		
	.63	9135		.47	1.57	1.97	1.24	.79	1.06	1.18	21.33			
	20	400	G 3/4	16	45	56	34,5	22	36	36	19,50	FI-GA-20SR-W3		
	.79	5800		.63	1.77	2.20	1.36	.87	1.42	1.42	42.90			
	25	400	G 1	20	49,5	61,5	37,5	24,5	41	46	25,14	FI-GA-25SR-W3		
	.98	5800		.79	1.95	2.42	1.48	.96	1.61	1.81	55.30			
	30	400	G 1 1/4	25	55,5	68,5	42	26,5	55	50	51,30	FI-GA-30SR-W3		
	1.18	5800		.98	2.19	2.70	1.65	1.04	2.17	1.97	112.86			
	38	315	G 1 1/2	32	59,5	74,5	43,5	28,5	60	60	62,80	FI-GA-38SR-W3		
	1.50	4568		1.26	2.34	2.93	1.71	1.12	2.36	2.36	138.16			

¹ Approximate dimension in assembled condition.

² Weight excluding cutting ring and union nut.

³ Standard scope of delivery: Fitting body only.

